



hoymiles HMT-2000-4T Series Microinverters Installation Guide

Contents

- [1 hoymiles HMT-2000-4T Series Microinverters](#)
- [2 Product Information](#)
- [3 Accessories](#)
- [4 Installation Steps](#)
- [5 Documents / Resources](#)
- [6 Related Posts](#)



hoymiles HMT-2000-4T Series Microinverters



Product Information

HMT-2000-4T Series Microinverters

The HMT-2000-4T Series microinverters are designed to convert the DC power output from a single photovoltaic (PV) module into grid-compliant AC power. These microinverters are compatible with HMT-1600/1800/2000-4T models and come with a range of accessories to aid in installation.

Accessories

Item	Description
A	3P-AC Trunk Cable, 12/10 AWG Cable
B	M8 × 25 screws (Prepared by the installer)
C	Grounding Accessory
D	3P-AC Trunk Connector
E	3P-AC Trunk Port Cap
F	3P-AC Trunk Port Disconnect Tool
G	3P-AC Trunk End Cap
H	3P-AC Trunk Connector Unlock Tool

The following accessories can be purchased separately and are not included in the package:

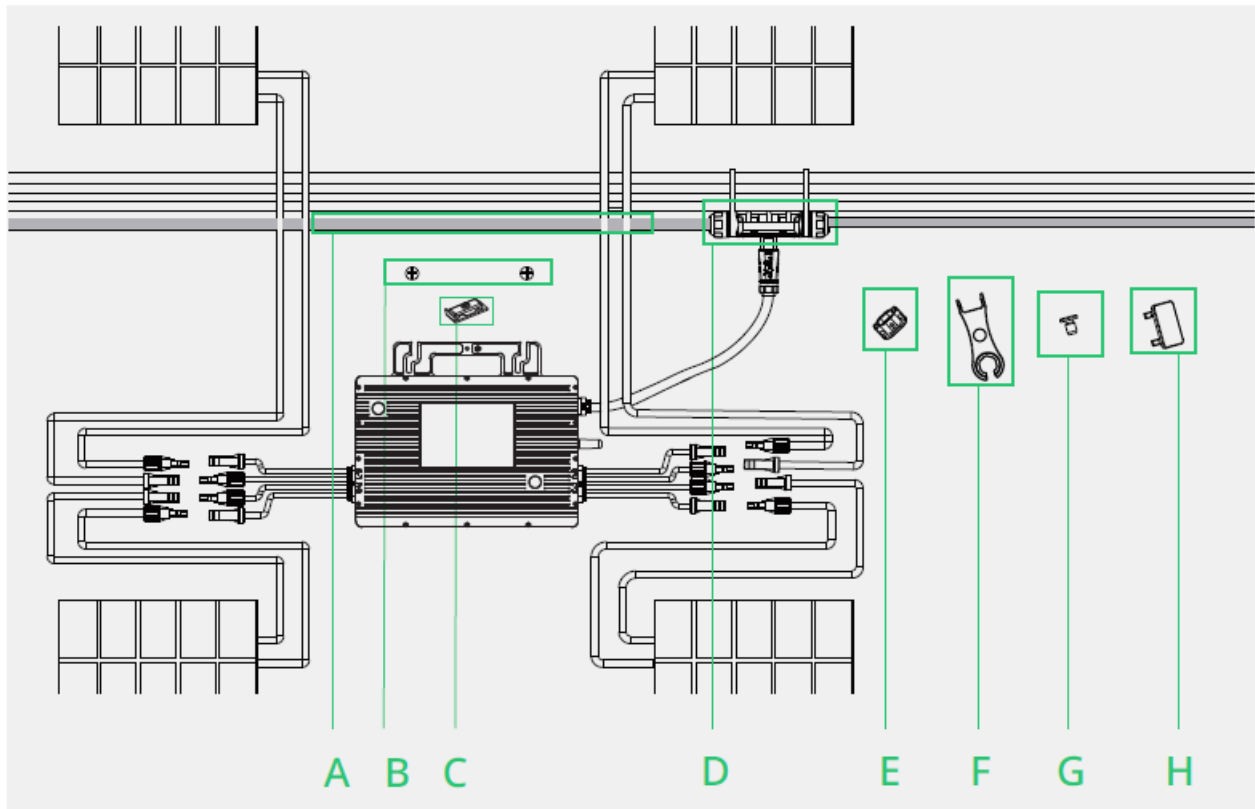

- Grounding Accessory
- 3P-AC Trunk Connector
- 3P-AC Trunk Port Cap
- 3P-AC Trunk Port Disconnect Tool
- 3P-AC Trunk End Cap
- 3P-AC Trunk Connector Unlock Tool

Installation Steps

The installation process involves planning and installing the microinverters, building the 3P-AC trunk cable, completing the AC connection, and creating an installation map.

Step 1. Plan and Install the Microinverter

1. Mark the position of each microinverter on the rail according to the PV module layout.
2. Fix screws on the rail.

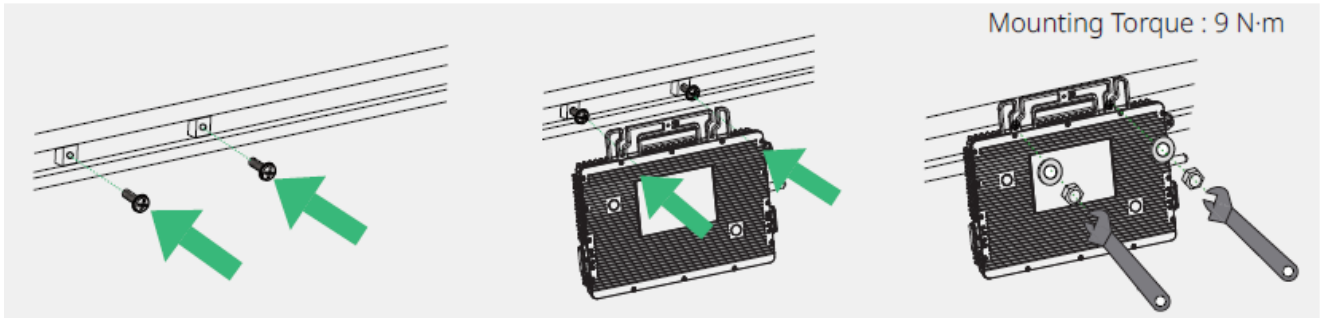

3. Hang the microinverter (label side up) on the screws and beneath the PV module. Then tighten the screws.

Note:

1. Install the microinverter and all DC connections under the PV module to avoid direct sunlight, rain exposure, snow buildup, UV, etc.
2. Leave at least 2 cm of space around the microinverter enclosure to ensure ventilation and heat dissipation.
3. Mounting torque of the 8 mm screw should be 9 N·m. Please do not over-torque

Step 2. Plan and Build the 3P-AC Trunk Cable

The 3P-AC Trunk Cable is used to connect the microinverter to the distribution box.

1. Determine how many microinverters you plan to install on each AC branch and prepare AC Trunk Connectors accordingly.
2. Take out segments of AC Trunk Cable as you need to make an AC branch.
 - Disassemble the AC Trunk Connector and remove the cable.
 - Use the 3P-AC Trunk Connector Unlock Tool to unlock the connector upper cover.

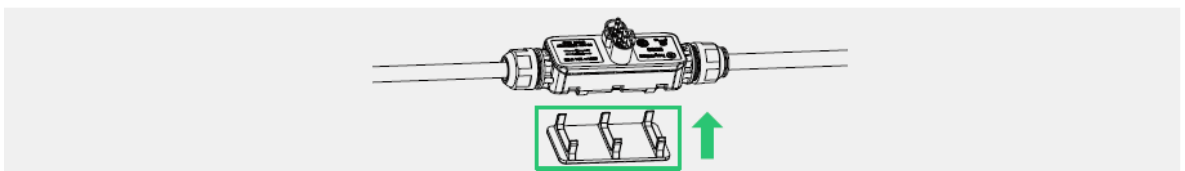

- Loosen the three screws with a screwdriver. Untighten the cap and remove the cable.

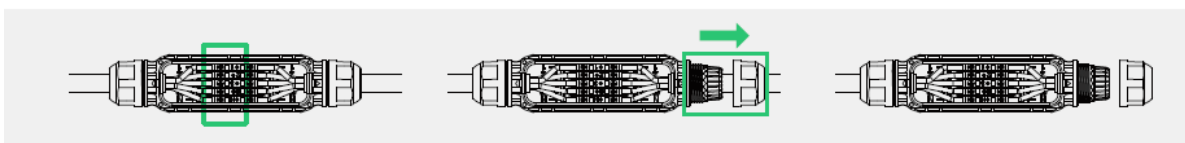

- Install the 3P-AC Trunk End Cap at one side of the 3P-AC Trunk Cable (the end of 3P-AC Trunk Cable).
 - Insert the 3P-AC Trunk End Cap and screw the cap back to port, then tighten the cap.

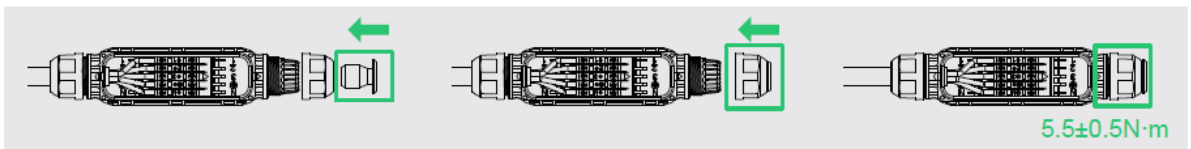

- Plug the upper cover back to the Trunk connector.

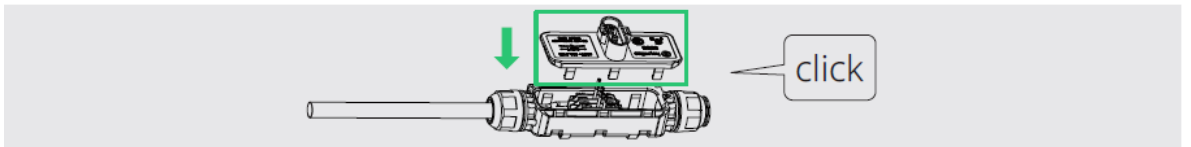

- Install the AC end cable on the other side of 3P-AC Trunk Cable (connected to the distribution box).
 - Unlock the port upper cover, loosen the screws with a screwdriver and remove the extra cable. (Skip this step if there is no cable at this side.)

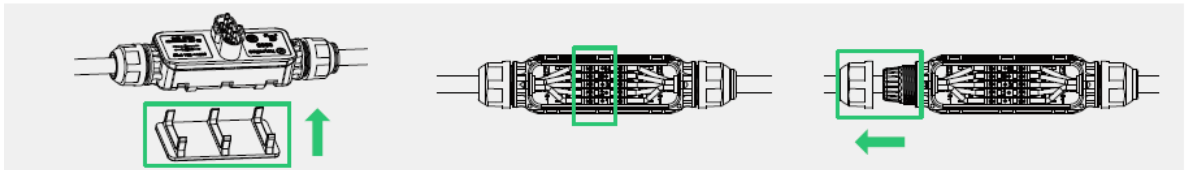

- Prepare a segment of AC cable with suitable length to connect to the distribution box, with stripping requirements fulfilled.

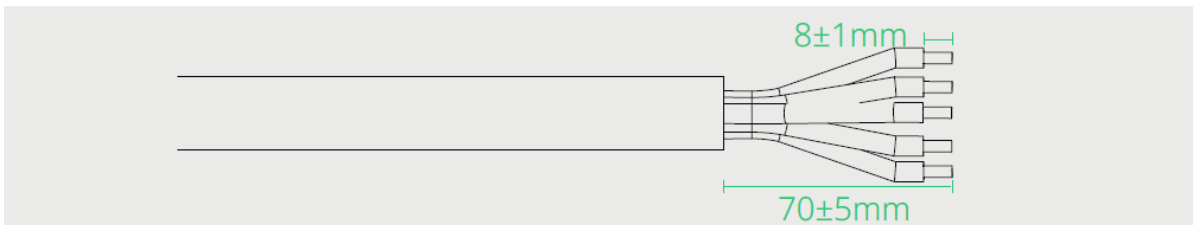

- Insert the cable into the cap in a way that L1, L2, L3, PE, and N lines are in corresponding slots.

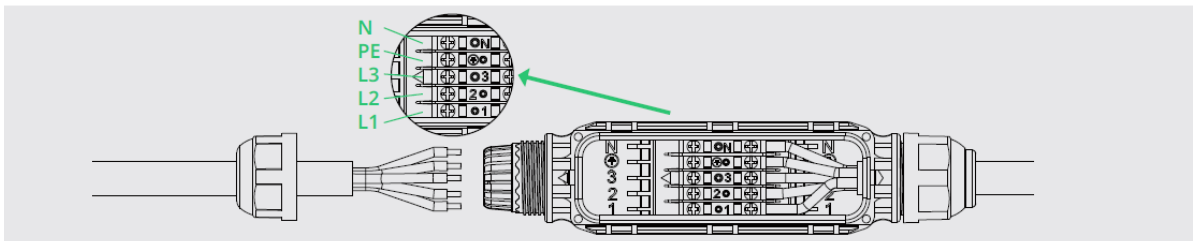

- Tighten the screws and tighten the cap back to the port.

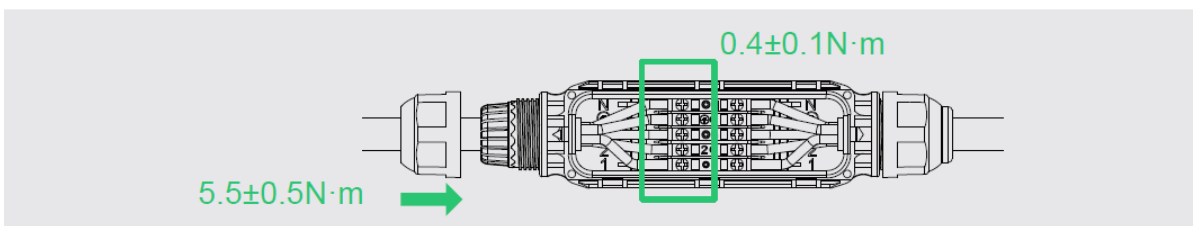

- Plug the upper cover back to the Trunk connector.

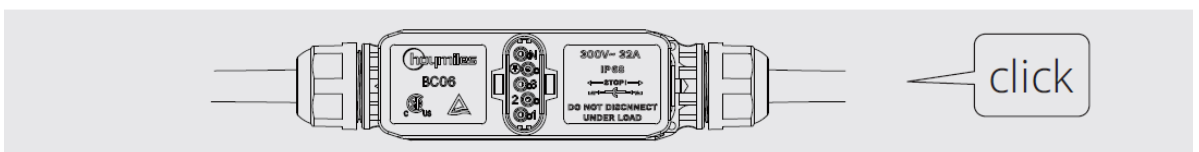

Note:

- Tightening torque of the cap: 5.5 ± 0.5 N·m. Please do not over-torque.
- Torque of locking screw: 0.4 ± 0.1 N·m.
- Do not damage the sealing ring in the 3P-AC Trunk Connector during disassembly and

assembly

3. Repeat the above steps to make all the 3P-AC Trunk Cables you need, then lay out the cable on the rail in a suitable position so that the microinverters can be connected to the Trunk connectors.
4. Attach the 3P-AC Trunk Cable to the mounting rail and fix the cable with tie wraps.

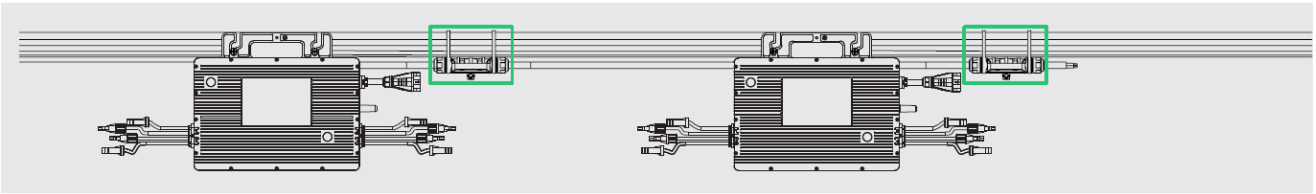

Step 3. Complete the AC Connection

1. Push the AC Sub Connector from microinverter to the 3P-AC Trunk Connector until it clicks.

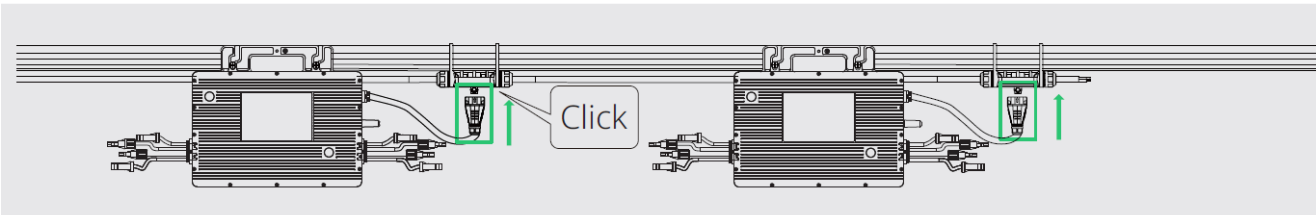

2. Connect the AC end cable to the distribution box, and wire it to the local grid network.
3. Plug the 3P-AC Trunk Port Cap in any vacant AC Trunk Port to make it water and dust-proof.

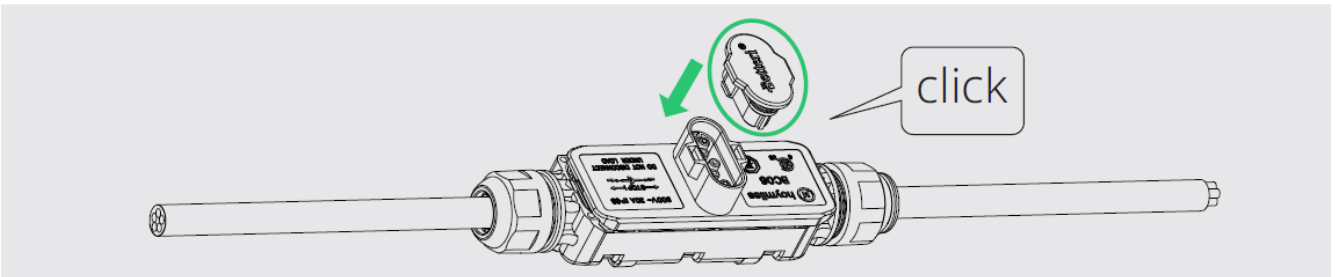

Note:

1. Make sure that the 3P-AC Trunk Connectors are kept away from any water-channeling surface.
2. In case you need to remove the microinverter AC cable from 3P-AC Trunk Connector, please use the 3P-AC Trunk Port Disconnect Tool and insert the tool into the side of AC Sub Connector to complete the removal.

Step 4. Create an Installation Map

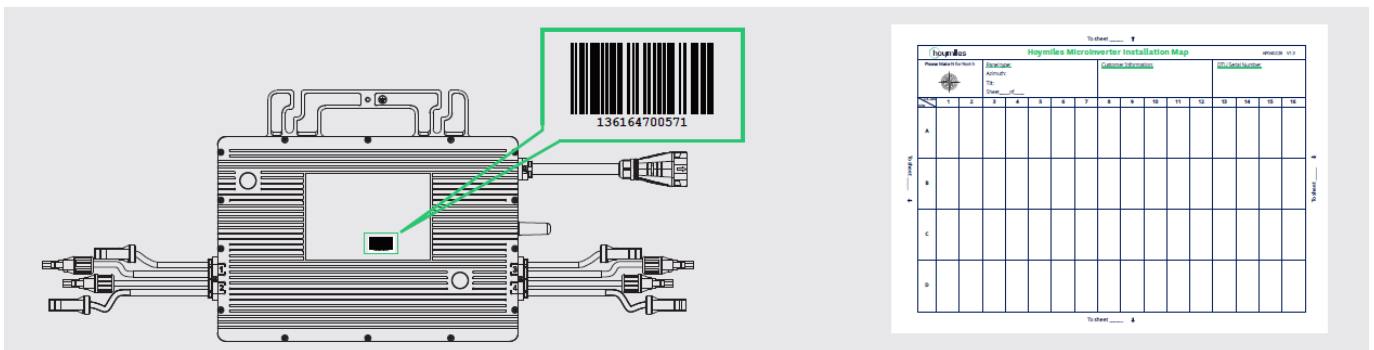

Create an installation map of your microinverter system for future reference.

- Peel the removable serial number label (as shown) from each microinverter.
- Affix the serial number label to the respective location on the installation map

Step 5. Connect PV Modules

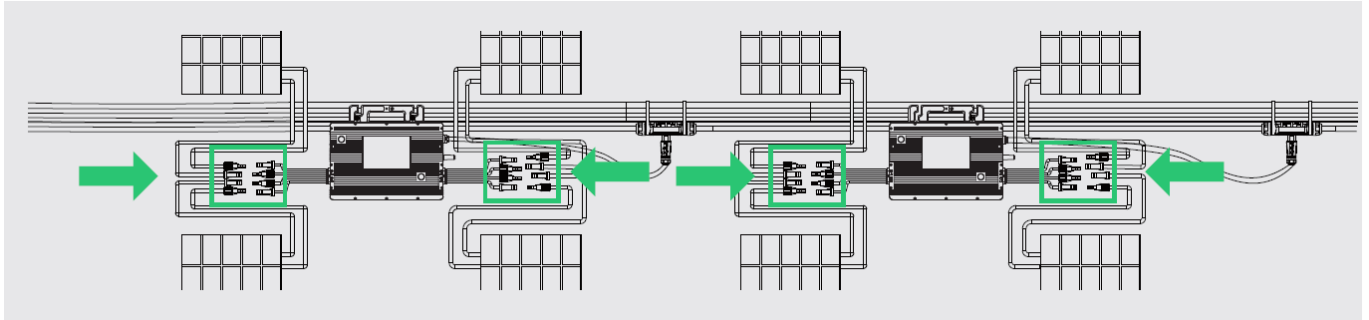

- Mount the PV modules above the microinverter.
- Connect the PV modules' DC cables to the DC input side of the microinverter

Note: Please use the DC extension cable when the length of DC cable is insufficient to reach the desired location

Note:

1. Make sure that the 3P-AC Trunk Connectors are kept away from any water-channeling surface.
2. In case you need to remove the microinverter AC cable from 3P-AC Trunk Connector, please use the 3P-AC Trunk Port Disconnect Tool and insert the tool into the side of AC Sub Connector to complete the removal.

Step 6. Energize the System

- Turn on the AC breaker for the branch circuit.
- Turn on the main AC breaker for the house. Your system will start to generate power in about two minutes.

Step 7. Set up Monitoring System

Please refer to the DTU User Manual or DTU Quick Installation Guide, and Quick Installation Guide for S-miles Cloud to install the DTU and set up monitoring system.

Product information is subject to change without notice. (Please download reference manuals at www.hoymiles.com).

Region: Global AP040796 REV1.1 © 2023 Hoymiles Power Electronics Inc. All rights reserved

Documents / Resources

	<p>hoymiles HMT-2000-4T Series Microinverters [pdf] Installation Guide HMT-1600-4T, HMT-1800-4T, HMT-2000-4T, HMT-2000-4T Series Microinverters, HMT-2000-4T Series, Microinverters</p>
--	--

